

Jamboree GT

CLASS C

SPA



BLUE TOPAZ



EBONY



FULL-BODY PAINT

- SATIN STEEL (SHOWN)
- RACEWAY RED
- SILVER LEAF
- BLUE TOPAZ
- PLATINUM



FLEETWOOD
Driven to Explore

INTERIOR DECORS

Spa

LIVING/DINING ROOM



Dinette Cushions



Sofa



Ultraleather™ Driver & Front Passenger Seats, Sofa (Optional)

BEDROOM



Bedspread & Headboard



Accent Fabric



Throw Pillow

Blue Topaz

LIVING/DINING ROOM



Dinette Cushions



Sofa



Ultraleather™ Driver & Front Passenger Seats, Sofa (Optional)

BEDROOM



Bedspread & Headboard



Accent Fabric



Throw Pillow

Ebony

LIVING/DINING ROOM



Dinette Cushions

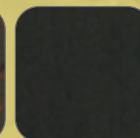

Sofa



Ultraleather™ Driver & Front Passenger Seats, Sofa (Optional)

BEDROOM



Bedspread & Headboard

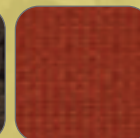

Accent Fabric

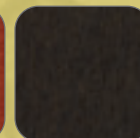

Throw Pillow

Wood Finishes



Windsor Birch



Plantation Cherry

FLOOR PLANS

30H Double Slide-Out

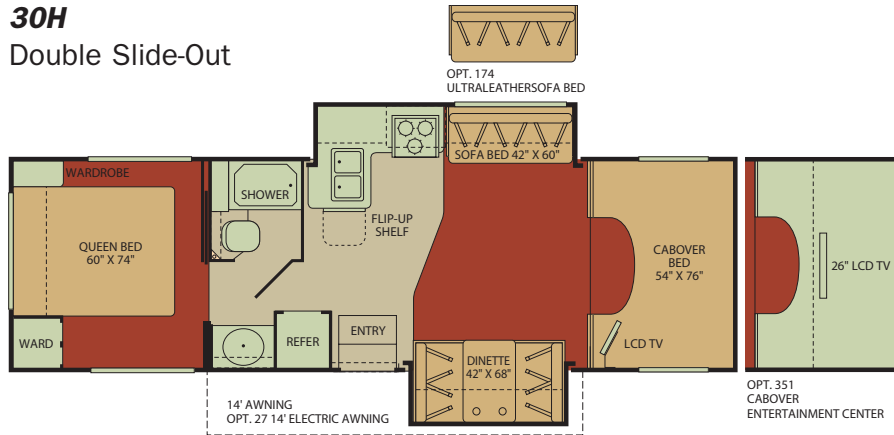

Interior Storage Capacity: 70 cu. ft.
Exterior Storage Capacity: 78 cu. ft.

30U Double Slide-Out

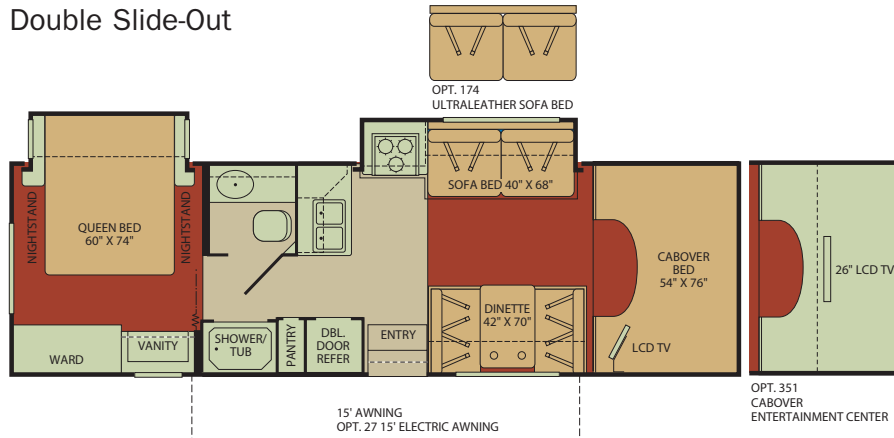

Interior Storage Capacity: 140 cu. ft.
Exterior Storage Capacity: 85 cu. ft.

31L Single Slide-Out

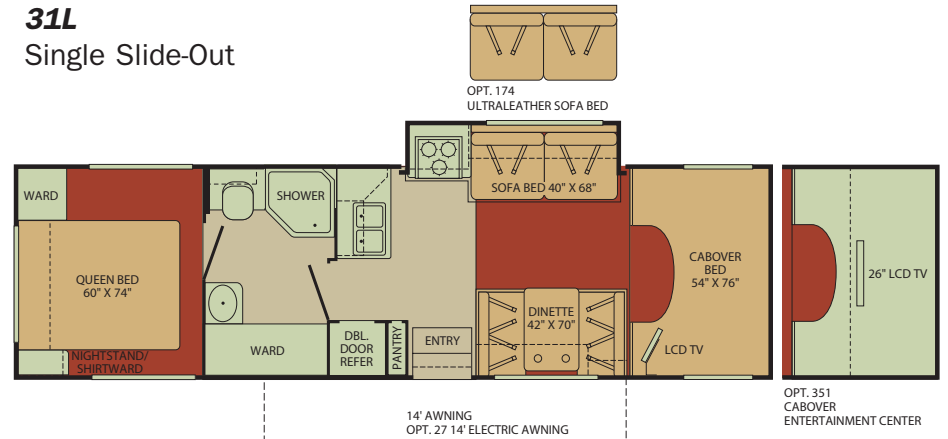

Interior Storage Capacity: 129 cu. ft.
Exterior Storage Capacity: 42 cu. ft.

31W Single Slide-Out

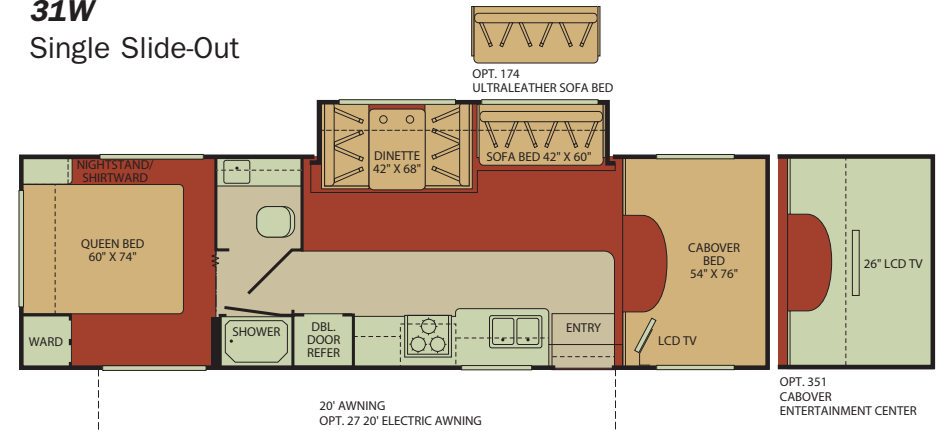

Interior Storage Capacity: 101 cu. ft.
Exterior Storage Capacity: 61 cu. ft.

STANDARD FEATURES

INTERIOR

INTERIOR THROUGHOUT

- Complete TuffPEX Plumbing System
- 12V Water Pump, Demand Operation
- 15,000 BTU Ducted Air Conditioner
- 30,000 BTU Furnace, Auto Ignition, Ducted, Wall Mounted Thermostat
- 6 Gallon Water Heater, Electronic Ignition, Propane
- Arch Hardwood Overhead Cabinet Doors w/Raised Panel
- Auxiliary Battery, Disconnect Switch on Monitor Panel
- Carpet w/Pad & Vinyl Flooring in Galley, Lavy & Entry
- Deluxe Roller Bearing, Full Extension Drawer Guides & Transit-Ship Locks
- Water Pump Controller, On/Off Switches at Galley & Lavy
- Quality Constructed Furniture by Flexsteel®
- Water Heater Bypass Valve Fresh Water System Winterization
- Mortise & Tenon Hardwood Cabinet Doors
- Monitor Panel: Auxiliary & Chassis Battery Condition Check, Holding Tank Levels, Fresh Water Tank Level, Propane Tank Level, All Level Readings in 1/4 Increments, Direct Spark Ignition Water Heater Switch w/Lighted Indicator, Water Pump Switch w/On Indicator Light, Battery Disconnect Switch, Generator Start/Stop Switch & Hour Meter
- GFI Circuit Protection in Galley, Lavy, Patio Receptacles
- AC/DC Load Center w/12V Converter/Battery Charger

DRIVER CONVENIENCE

- 3 Point Seat Belts at Driver & Front Passenger Seats
- 4 Speakers (2 in Cab Doors, 2 Ceiling Mounted)
- In-Dash AM/FM/Radio w/CD/DVD Player
- Power Windows & Door Locks
- 54" X 76" Cabover Bed with Patented Slider Bunk Operation, Privacy Curtain, Roof Vent & Sliding Side Windows
- Cabover Bunk Ladder (Supplied w/Cabover Bunk Arrangement)
- Driver/Front Passenger Airbag Supplemental Restraint System
- Driver/Front Passenger Ultraleather™ Flexsteel® Adjustable/Reclining Bucket Seats w/Armrest
- Custom Dash Appliqués

LIVING ROOM

- 2 Cup Holders in Dinette
- Ceiling Lights w/Wall Switches (Entry & Bath)
- Day/Night Pleated Shades
- Dinette, Convertible for Sleeping

- Large Viewing Window at Dinette
- Sofabed w/Armrests, Convertible for Sleeping

GALLEY

- 3 Burner Range w/High Output/Piezo Ignitor & Oven
- Decor Wall Border
- Dometic® 8 cu.ft. Refrigerator/Freezer
- Drawer Boxes w/Real Wood Construction
- Flip-Up Counter Top Extension (Select Models)
- Kitchen Convenience Package: Knife Holder, Spice Rack, Hardwood Paper Towel Holder, Sink Cover/Cutting Board, Silverware Drawer
- Microwave/Convection Oven
- Raised Panel Refrigerator Inserts
- Rangehood w/Light & Fan
- Residential Size Double Bowl Sink
- Residential Style Single Lever Faucet
- Whole Coach Water Filtration System
- Soap Dispenser

BEDROOM

- Bedspread w/Pillow Shams
- Night Pleated Shades
- Roof Vent (Select Models)
- Decorative Reading Lights
- Innerspring Mattress

BATHROOM

- Bath Door w/Residential Passage Lock and Towel Bars
- China Bowl Toilet w/Hand Sprayer
- Medicine Cabinet w/Wood Construction
- Shower Head w/Flexible Hose Extension
- Skylight/Roof Vent w/12V Fan
- Wall Mounted Mirror
- Molded ABS Shower/Tub Surround/Pan
- Residential Style Metal Faucet w/Large Sink
- Glass Shower Door Enclosure

SAFETY/CONVENIENCE

- 10 ABC Fire Extinguisher
- Carbon Monoxide Detector/Alarm
- Exterior & Interior Entry Assist Handle
- Propane Detector/Alarm
- Smoke Detector/Alarm

EXTERIOR

EXTERIOR THROUGHOUT

- City Water Hook-Up
- High Gloss Tuff-Coat® Smooth Fiberglass Exterior
- Outstanding Exterior Graphics and Styling
- Onan® 4.0kW Microquiet Generator
- Large 1" (Inside Diameter) Water Tank Drain
- Rear Ladder

- Utility Compartment w/Exterior Shower & Holding Tank Dump Valves
- Aluminum Basement Truss System
- EZ Glide® Slide-Out Room and Compartment (Select Models)
- Debris Awning w/All Slide-Out Rooms
- Patio Awning
- Full Size Spare Tire (Select Models)

AUTOMOTIVE

- Ford® E450 Chassis, 6.8L Triton V10 w/305HP, Dual Airbags, 4W Anti Lock Brakes, Automatic 5 Speed Transmission w/Overdrive
- Trailer Hitch w/7 Pin Electrical Hook-Up
- Auxiliary Emergency Start Assist Switch on Dash
- Chassis Supplied: Heating & Air Conditioning, Cigarette Lighter/12V Power Supply, Intermittent Windshield Wipers, Power Steering w/Tilt Wheel, Cruise Control, Sunvisors (2), Dome Light, Beverage Cup Holders, Map Pocket
- AC/DC Load Center w/12V Converter/Battery Charger
- Rear Fuel Fill (Select Models)
- Alcoa® Aluminum Wheels
- Dual 6V Deep Cycle Auxiliary Batteries

SAFETY/CONVENIENCE

- 30 Amp, 30' Long Shore Line Power Cord, Compartment Storage
- AC Duplex GFI Receptacle on Patio Side
- Amber Porch Light w/Interior Switch
- Entry Door w/Screen Door & Deadbolt Lock
- High Mounted Large Taillights
- Radius Tinted Windows
- Power Electric Step
- Breakaway Side Mirrors w/Power Adjust & Heat Control

STORAGE

- Molded Cross Link Polyethylene Battery Compartment Container & Lid, Easy Access for Battery Maintenance & Electrical Components Check
- Painted Aluminum Skin Luggage Doors w/Strut Assist and Paddle Latches
- Stainless Steel Hinges on Exterior Luggage Doors

BODY STRUCTURE

- Vacu-bond® Floor
- Vacu-bond® Hull Lamination Process
- Royal Tuff-Ply Radius Roof w/Ducted A/C
- Sidewalls Framed w/1 1/2" Aluminum Tubing
- Corrosion Resistant Aluminum Tube Hull Framing
- Molded Rear Wheel Trim Flares
- Molded Rear Wall/Ceiling Transition Trim
- Steel Powder Coated Rear Bumper
- One-Piece Molded Fiberglass Front End Cap

- 26" Wide Radius Corner Entry Door w/Window
- Powder Coated Steel Running Boards w/Custom Molded Front Wheel Trims
- Heated Holding Tanks in Basement Compartments
- Full Basement Exterior

OPTIONS

INTERIOR THROUGHOUT

- 15,000 BTU A/C with Heat Pump

LIVING ROOM

- Cabover Entertainment System: 26" LCD TV w/Home Theater System
- Ultraleather™ Sofa Bed

EXTERIOR THROUGHOUT

- Full-Body Paint
- Exterior Entertainment Center w/AM/FM/CD Player and Auxiliary Speaker, Coax Cable & 12V/110 Receptacles
- DSS Manual Lift Satellite Dish w/Elevation Sensor
- Toilet Tank San-T-Flush™ System
- Electric Awning (Full-Body Paint Only)

SAFETY/CONVENIENCE

- Rear Vision Camera

FLEETWOOD ADVANTAGES

- **One-Piece Molded Fiberglass Front End Cap**
- **3 Interior Decors and 2 Wood Choices Provide 6 Different Looks Tailored to Your Preferences**
- **4 Floors Plans from 30' to 31' with Single or Double Slide-Outs to Suit Your RV**
- **Vacu-bond® Walls with Smooth High Gloss Exterior Tuff-Coat® Fiberglass**
- **5 Full-Body Paint Options**
- **Extended Season Camping with Enclosed/Heated Water & Holding Tanks**

Jamboree GT

WEIGHTS & MEASUREMENTS

WEIGHTS

MODELS	30H	30U	31L	31W
Chassis	Ford® E450	Ford® E450	Ford® E450	Ford® E450
Engine Displacement (Liters)	6.8	6.8	6.8	6.8
Wheelbase (Inches)	206"	206"	218"	214"
GVWR (lbs) ¹	14,050	14,050	14,050	14,050
Front GAWR (lbs) ²	4,600	4,600	4,600	4,600
Rear GAWR (lbs) ²	9,450	9,450	9,450	9,450
Base Weight (lbs) ³	11,860**	12,250**	12,000**	12,000**
GCWR (lbs) ⁴	19,050	19,050	19,050	19,050
Hitch Rating Weight (lbs) [†]	5,000	5,000	5,000	5,000
Tongue Weight (lbs) [†]	350	350	350	350

DIMENSIONS & CAPACITIES

MODELS	30H	30U	31L	31W
Overall Length ⁵	30'6"	30'6"	32'2"	31'4"
Overall Height (with A/C)	11'7"	11'7"	11'7"	11'7"
Overall Width (maximum) ^{6,7}	102"	102"	102"	102"
Interior Height (maximum)	82"	82"	82"	82"
Interior Width (maximum)	96"	96"	96"	96"
Fuel Capacity (gal)	55	55	55	55
Fresh Water Holding Tank (gal)	30	30	35	35
Grey Water Holding Tank (gal)	35	35	35	37
Black Water Holding Tank (gal)	35	35	37	35
Water Heater Tank (gal)	6	6	6	6
Appliance Propane Tank (gal) (WC) ⁸	14	14	14	14

Liquid Weight Reference: Water (gal) = (8.3 lbs/3.8kgs) Fuel (gal) = 7.1 lbs/3.2 kgs) Propane (gal) = (4.2 lbs/1.9 kgs)

Metric Conversion: Multiply pounds x 0.453 to obtain kilograms. Multiply gallons x 3.785 to obtain liters. Multiply liters x 61 to obtain cubic inches.

CHASSIS

Model: Ford® E450

Engine: E6.8L Triton V10

Torque: 420 lb-ft @ 3250 RPM

Alternator Amps: 115 Amp

Horsepower: 305HP

Transmission: 5-Speed Automatic w/Overdrive

- GVWR (Gross Vehicle Weight Rating) is the maximum permissible weight of this fully loaded motor home. The GVWR is equal to or greater than the sum of the (UVW) unloaded vehicle weight plus the (CCC) cargo carrying capacity*.
- GAWR (Gross Axle Weight Rating) is the maximum permissible loaded weight a specific axle is designed to carry.
- Base Weight is the estimated weight of the motor home without fuel, options, water, cargo or passengers.
- GCWR (Gross Combined Weight Rating) is the value specified by the motor home manufacturer as the maximum allowable loaded weight of this motor home with its towed vehicle. Towing and braking capacities may be different. Refer to Fleetwood and chassis manufacturer's manuals for complete information.
- Length measured from front bumper to rear bumper (excludes accessories).
- Excludes safety equipment and awnings.
- Motor homes feature a body-width over 96" which will restrict your access to certain roads. Before purchasing, you should research any state and/or province road laws which may affect your usage.
- Tank manufacturer's listed water capacity (WC). Actual propane capacity is 80% of water listing as required by the safety code.

† The chassis manufacturer recommends the installation of a supplemental brake control system to activate the brakes on the vehicle or trailer you are towing. Hitch receiver ratings expressed are maximum for the hitch receiver installed and may require the purchase of additional equipment that is dependent on the weight of the towed load. Consult with hitch receiver manufacturer for further information.

N/A = not available at time of printing.

* UVW and CCC are found on the cargo carrying capacity label in each RV.

** Estimated Weights.

IMPORTANT — PLEASE READ: Product information, photography and illustrations included in this publication were as accurate as possible at the time of printing. For further product information and changes, please visit our website at www.fleetwoodrv.com or contact your local Fleetwood dealer. Prices, materials, design and specifications are subject to change without notice. All weights, fuel, liquid capacities and dimensions are approximate. Fleetwood has designed its recreational vehicles to provide a variety of uses for its customers. Each vehicle features optimal seating, sleeping, storage and fluid capacities. The user is responsible for selecting the proper combination of loads (i.e. occupants, equipment, fluids, cargo, etc.) to ensure that the vehicle's capacities are not exceeded.