

Discovery

CLASS A DIESEL



Pacific Blue



Red Wine

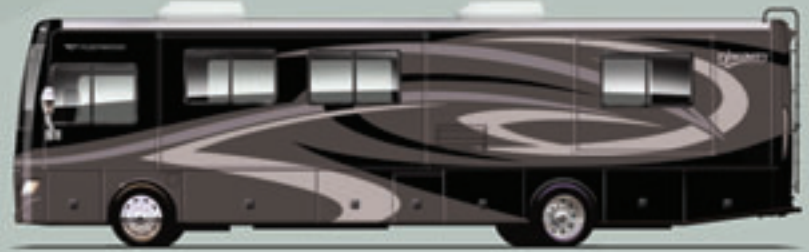

Iron

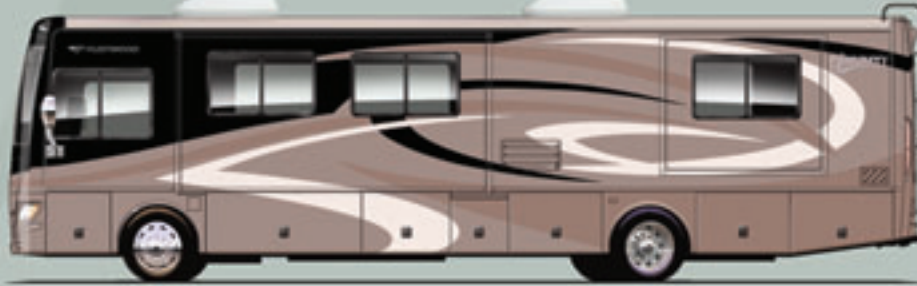

Stone

FLEETWOOD
Driven to Explore

INTERIOR DECORS

Café Milan

LIVING/DINING ROOM



Dinette Cushions



Sofa



Driver & Front Passenger Seats, Sofa (optional)

BEDROOM



Bedspread

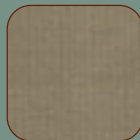

Pillow Shams



Throw Pillows

Cognac

LIVING/DINING ROOM



Dinette Cushions



Sofa



Driver & Front Passenger Seats, Sofa (optional)

BEDROOM



Bedspread



Pillow Shams



Throw Pillows

Truffle

LIVING/DINING ROOM



Window Treatment



Sofa & Dinette Cushions



Driver & Front Passenger Seats, Sofa (optional)

BEDROOM



Bedspread



Pillow Shams

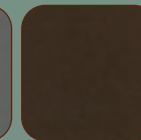

Throw Pillows

Wood Finishes



Windsor Birch



Summit Ash



Plantation Cherry

FLOOR PLANS

35H

Triple Slide-Out

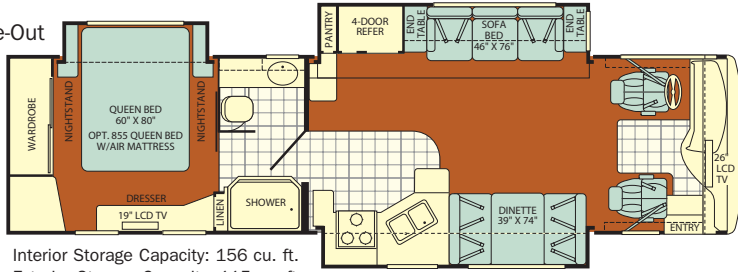

Interior Storage Capacity: 156 cu. ft.
Exterior Storage Capacity: 115 cu. ft.

Available Options: 113, 126, 127, 200, 497, 833, 873

39R

Full-Wall Slide
Triple Slide-Out

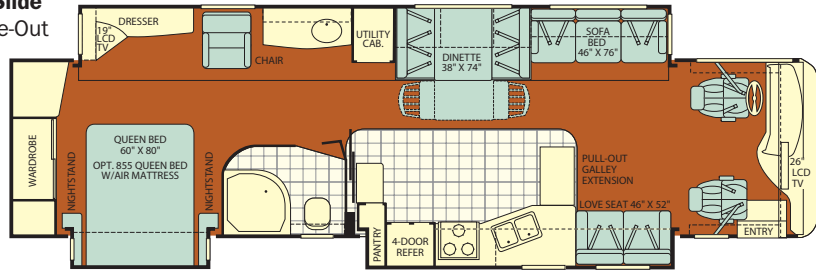

Interior Storage Capacity: 260 cu. ft.
Exterior Storage Capacity: 201 cu. ft.

Available Options: 113, 126, 127, 173, 197, 200, 497, 821, 832, 833, 874

39V

Full-Wall Slide
Double Slide-Out

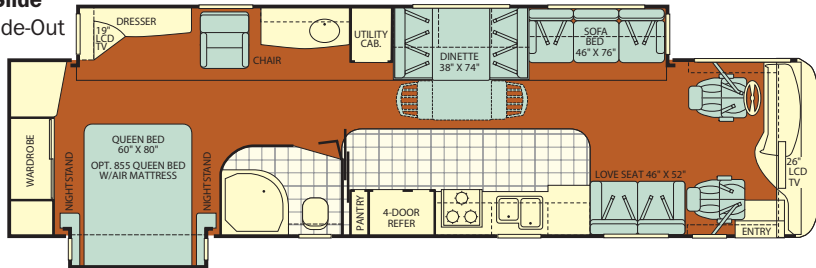

Interior Storage Capacity: 186 cu. ft.
Exterior Storage Capacity: 189 cu. ft.

Available Options: 113, 126, 127, 173, 197, 200, 491, 497, 832, 833

39L

Quad Slide-Out

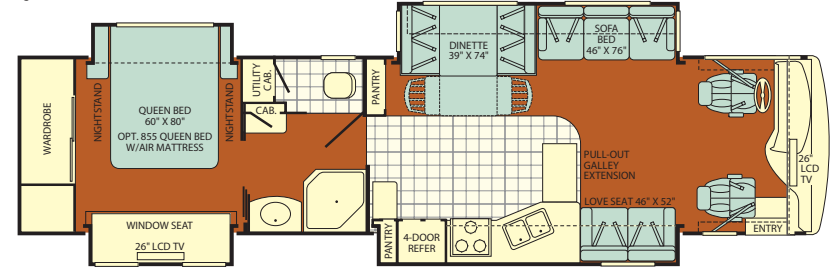

Interior Storage Capacity: 198 cu. ft.
Exterior Storage Capacity: 162 cu. ft.

Available Options: 113, 126, 127, 173, 197, 200, 497, 821, 832, 833, 874

39S

Triple Slide-Out

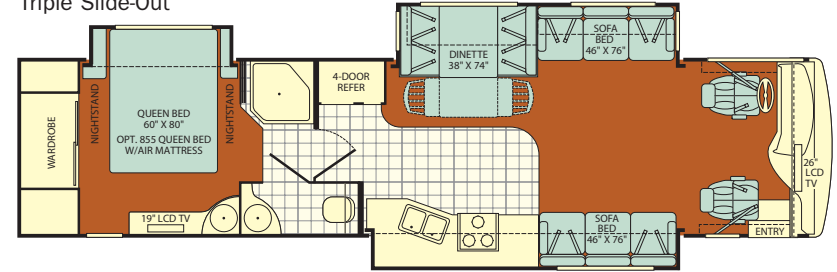

Interior Storage Capacity: 179 cu. ft.
Exterior Storage Capacity: 162 cu. ft.

Available Options: 113, 126, 127, 154, 197, 200, 201, 497, 804, 832, 833

40X

Triple Slide-Out

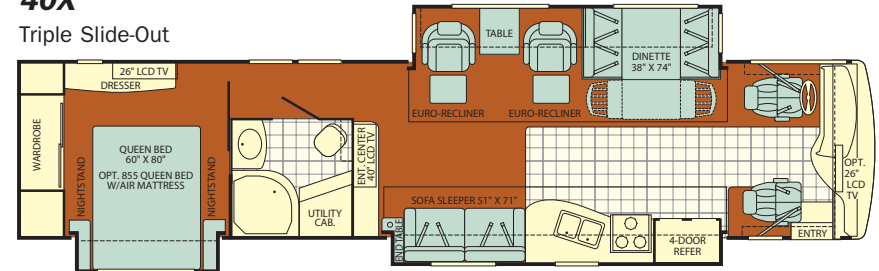

Interior Storage Capacity: 209 cu. ft.
Exterior Storage Capacity: 206 cu. ft.

Available Options: 113, 126, 127, 174, 201, 497, 832, 833

OPTIONS

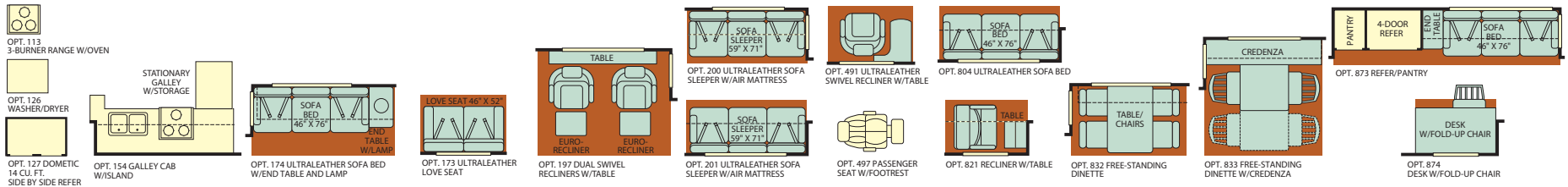

STANDARD FEATURES

INTERIOR

INTERIOR - THROUGHOUT

- 10 Gallon Quick Recovery Water Heater w/Direct Spark Ignition (Gas/Electric)
- 20,000/25,000 BTU Dual Furnaces
- 20,000/30,000 BTU Dual Furnaces (39V)
- 84" Interior Ceiling Height
- Complete TuffPEX Plumbing System
- Crown Molding
- Deluxe Roller Bearing, Full Extension Drawer Guides & Transit-Ship Locks
- Demand Water Pump w/Filter
- Dual Roof Mounted A/C High Efficiency w/Solar Panel & Chill Grill on Front A/C
- Hardwood Cabinet Doors/Drawers
- Laminate Floor Tile
- Plush Wall-to-Wall Carpet w/Carpet Pad
- Wall Sconces
- Wall Switches (Includes Switches for Ceiling Lights & Vents)
- Water Heater Bypass
- Whole Coach Water Filtration System
- Wood Finish Return Air Intake for Furnace

DRIVER CONVENIENCE

- Adjustable 3 Point Seat Belts at Driver & Front Passenger Seats (with adjustable shoulder strap)
- AM/FM Radio w/CD - Sirius Satellite Ready
- Color Back-Up Monitor
- Auxiliary Start Circuit
- Battery Shut-Off Switch
- CB Radio Ready
- Cruise Control
- Driver Side Manual Pull Down Shade
- Driver/Front Passenger Ultraleather™ Captain's Chairs w/Reclining Back/Slide Controls w/Power Driver Seat
- High-Output Auto A/C Heater Combo
- Passenger Armrest w/Integrated Magazine Rack
- Power Driver/Front Passenger Sun Visors
- Radio Switch Main/Auxiliary Power
- Snack Tray/Service Door at Dash
- Soft Surface Automotive Dash
- Tilt/Telescoping Steering Wheel

GALLEY

- 1.4 cu.ft. Convection Microwave Oven
- 3 Burner, High-Output Cooktop w/Sealed Burners
- Adjustable Cabinet Shelves (Select Cabinets)
- Fan-Tastic® Power Roof Vent w/Wall Switch
- Light/Power Range Hood
- Norcold® 12 cu.ft. 4 Door Refrigerator w/Ice Maker and Water Dispenser
- Roll-Out Counter Top (39L &39R)
- Moen® Galley Faucet w/Pullout Sprayer
- Six Person Pull-Out Dinette Table (Select Models)
- Slide-Out Dinette Drawers w/Latches
- Soap Dispenser
- Solid Surface Counter Top, Sink & Range Covers
- Under Galley Shelving & Wastebasket

- Window Over Sink
- Wood Trim Dinette Tabletop (Select Models)

LIVING ROOM

- Samsung® 26" HD LCD TV (40" in 40X)
- Samsung® AM/FM/DVD Home Theater Sound System w/Hidden Surround Sound Speakers
- Flexsteel® Residential Seat Styling
- TV Antenna

BEDROOM

- Samsung® 19" HD LCD TV (26" in 40X & 39L)
- Samsung® AM/FM/DVD Home Theater w/5.1 Dolby® Surround Sound Speakers
- Slide-Out Features Overhead Cabinet
- Dresser/Vanity w/Second Sink (Some Models)
- Bedspread w/Décor Pillows
- Coffin Ceiling
- Day/Night Pleated Shades
- Remote Generator Start
- Restonic® Deluxe Pillow Top Innerspring Mattress
- Ventilated Rear Wardrobe w/Cedar Lining, Carpeted Floor & Wire Organizer
- Wardrobe Lighting

BATHROOM

- A/C Venting
- Cabinet Toe Kicks
- Coordinated Bath Accessories
- Fan-Tastic® Power Roof Vent w/Wall Switch
- Glass Shower w/Skylight and Low Threshold
- Moen® Faucet
- Hardwood Bath Door/Trims
- Lighted Assist Handle
- Make-Up Lights (Some Models)
- Porcelain Toilet w/Water Saver

SAFETY/CONVENIENCE

- 20' Sewer Hose
- Easy Sweep Tile Flooring at Entry Step
- Energy Management System (EMS) w/Soft Start
- Entry Door w/Screen Door & Deadbolt Lock
- Four 6V/Deep Cycle House Batteries
- Lighted Exterior Entry Assist Handle
- Power Entry Step
- Remote Heated Rear View Mirrors
- Toilet Tank San-T-Flush™ System
- Touch Sensor Tank Monitor System
- Utility Compartment w/Exterior Shower

EXTERIOR

EXTERIOR - THROUGHOUT

- 120V/12V AC/DC Converter
- 120V/12V Wire Raceways
- 2000 Watt Pure Sine Wave Inverter w/Remote
- 4 Point Automatic Levelers
- 50 Amp Service
- 8.0 kW Onan® Quiet Diesel Generator
- Awning Rail/ Drip Molding (Both Sides)
- Choice of Three Colorway Graphics
- Doorside Patio Receptacle

- DSS Auto Locating Satellite Dish (Covered)
- Dual Pane Windows w/Screens
- Fiberglass Front Quarter Panels
- Fiberglass Wheel Well Trims
- Full-Body Paint
- Two Stage Luggage Door Struts
- Weather Pro Power Awning (Patio Awning Includes Wind Sensor)
- Fiberglass Front/Rear Caps w/High Mounted Taillights
- Water Pump Switch (Multiple Locations)

AUTOMOTIVE

- 10,000 lb. Weight Distributing Hitch Receiver w/7 Point Electrical Hook-Up
- Aluminum Wheels
- Dual Fuel Fill (One on Each Side)
- Fog Lamps
- Mud Flaps
- Rear Vision Camera
- Remote Keyless Entry
- Single Motor Denso Windshield Wipers w/Wet Arm
- Underhood Utility Light
- Large One-Piece Bonded-in Windshield
- 350HP Cummins® ISB 6.7L Engine
- Freightliner® Chassis
- Chrome Exterior Mirrors

STORAGE

- Continuous One Piece Compartment Bulb Seal
- EZ Store Compartment on Living Area Slide-Outs
- Pass Through Storage (except 35H)
- Side Swinging Luggage Doors (Selected areas)
- Gas Lift Strut Supports (Two Stage Under Slide Box)
- Insulated Aluminum Luggage Doors w/Single Paddle Metal Latches & Stainless Steel Hinges
- Large Compartment Doors at EZ Store
- Lighted Luggage Compartments
- Rotomolded Polyethylene Luggage Compartments
- Spare Tire Compartment

BODY STRUCTURE

- Aluminum Interlocking Floor/Wall/Ceiling Framing
- Color Coordinated Royal Tuff-Ply Roof
- Heated Water & Holding Tank Compartments
- Power Platform Construction (Fleetwood Exclusive)
- Royal Tuff-Ply Radius Roof w/Ducted A/C
- Vacu-bond® Upper/Lower Floors

OPTIONS

INTERIOR - THROUGHOUT

- Central Vacuum System
- CSA Package (Canadian Specs)**
- Washer/Dryer
- Water Heater 16 Gallon Output

DRIVER CONVENIENCE

- Power Passenger Seat w/Power Footrest
- Blind Spot/Security Vision Package
- Automatic Generator Start Switch

GALLEY

- 14 cu.ft. Dometic® Frost-Free Refrigerator
- 3 Burner Sealed Drop-In Range w/Oven

LIVING ROOM

- Ultraleather™ Love Seat (39L)
- Ultraleather™ Sofa Bed
- Ultraleather™ Sofa Sleeper w/Air Mattress
- Samsung® 26" HD LCD TV in Front Overhead (40X)
- Computer Workstation at Dinette
- Dual Free-Standing Ultraleather™ Recliners
- Free-Standing Dinette w/Chairs
- Free-Standing Dinette w/Credenza
- Free-Standing Ultraleather™ Euro Recliner (39L)
- Recliner w/Table (39L)
- Desk (39L)

EXTERIOR - THROUGHOUT

- Exterior Entertainment Center w/Samsung® 19" TV and Stereo
- Exterior Pull-Out Grill & Kitchenette
- Heat Pumps
- Window Awnings
- Diamond Shield Clear Front Mask

AUTOMOTIVE

- Spotlight w/Remote Control

FLEETWOOD ADVANTAGES

- **Full-Wall Slide (Patent Pending) (Fleetwood Exclusive)**
- **350HP Cummins® ISB 6.7L Engine**
- **Vacu-bond® Walls w/Smooth High Gloss Exterior Tuff-Coat® Fiberglass**
- **Power Platform Construction (Fleetwood Exclusive)**
- **Large One-Piece Bonded-in Windshield**
- **Pass Through Storage**
- **Side Swinging Luggage Doors (Selected Areas)**
- **Samsung® 26" HD LCD TV in Living Room, Samsung® 19" HD LCD TV in Bedroom**
- **Deluxe Roller Bearing, Full Extension Drawer Guides**
- **84" Interior Ceiling Height**

**CSA Standards may require substitution or deletion to achieve conformance

WEIGHTS & MEASUREMENTS

FREIGHTLINER® CHASSIS

MODELS	35H	39L	39R	39S	39V	40X
Engine Displacement (Liters)	6.7	6.7	6.7	6.7	6.7	6.7
Wheelbase (Inches)	208"	252"	252"	252"	252"	276"
GVWR (lbs) ¹	31,000	31,000	31,000	31,000	31,000	31,000
Front GAWR (lbs) ²	12,000	12,000	12,000	12,000	12,000	12,000
Rear GAWR (lbs) ²	19,000	19,000	19,000	19,000	19,000	19,000
Base Weight (lbs) ³	22,260	24,000	24,000	23,700	24,000	24,000
GCWR (lbs) ⁴	41,000	41,000	41,000	41,000	41,000	41,000
Hitch Rating Weight (lbs) [†]	10,000	10,000	10,000	10,000	10,000	10,000
Tongue Weight (lbs) [†]	1,000	1,000	1,000	1,000	1,000	1,000
Fuel Capacity (gal)	90	90	90	90	90	90

DIMENSIONS & CAPACITIES

MODELS	35H	39L	39R	39S	39V	40X
Overall Length ⁵	35' 4"	39' 0"	39' 0"	39' 0"	39' 0"	41' 0"
Overall Height (with A/C)	12' 10"	12' 10"	12' 10"	12' 10"	12' 10"	12' 10"
Overall Width (maximum) ^{6, 7}	102"	102"	102"	102"	102"	102"
Interior Height (maximum)	84"	84"	84"	84"	84"	84"
Interior Width (maximum)	96"	96"	96"	96"	96"	96"
Fresh Water Holding Tank (gal)	86	86	86	86	86	86
Grey Water Holding Tank (gal)	50	50	50	50	50	50
Black Water Holding Tank (gal)	50	50	50	50	50	50
Appliance Propane Tank (gal) (WC) ⁸	38	38	38	38	38	38
Water Heater Tank (gal)	10	10	10	10	10	10

Liquid Weight Reference: Water (gal) = (8.3 lbs/3.8kgs) Fuel (gal) = 7.1 lbs/3.2 kgs) Propane (gal) = (4.2 lbs/1.9 kgs)

Metric Conversion: Multiply pounds x 0.453 to obtain kilograms. Multiply gallons x 3.785 to obtain liters. Multiply liters x 61 to obtain cubic inches.

CHASSIS

Model: Freightliner® XC-Series **Alternator Amps:** 170 Amp Lecce Neville®
Engine: Cummins® ISBXT 6.7L 350HP **Transmission:** Allison® 3000MH 6-Speed
Torque: 750 lbs-ft

- GVWR (Gross Vehicle Weight Rating) is the maximum permissible weight of this fully loaded motor home. The GVWR is equal to or greater than the sum of the (UVW) unloaded vehicle weight plus the (CCC) cargo carrying capacity*.
- GAWR (Gross Axle Weight Rating) is the maximum permissible loaded weight a specific axle is designed to carry.
- Base Weight is the estimated weight of the motor home without fuel, options, water, cargo or passengers.
- GCWR (Gross Combined Weight Rating) is the value specified by the motor home manufacturer as the maximum allowable loaded weight of this motor home with its towed vehicle. Towing and braking capacities may be different. Refer to Fleetwood and chassis manufacturer's manuals for complete information.
- Length taken from front bumper to rear bumper (excludes accessories).
- Excludes safety equipment and awnings.
- Motor homes feature a body-width over 96" which will restrict your access to certain roads. Before purchasing, you should research any state and/or province road laws which may affect your usage.
- Tank manufacturer's listed water capacity (WC). Actual propane capacity is 80% of water listing as required by the safety code.

† The chassis manufacturer recommends the installation of a supplemental brake control system to activate the brakes on the vehicle or trailer you are towing. Hitch receiver ratings expressed are maximum for the hitch receiver installed and may require the purchase of additional equipment that is dependent on the weight of the towed load. Consult with hitch receiver manufacturer for further information.

N/A = not available at time of printing.

* UVW and CCC are found on the cargo carrying capacity label in each RV.

IMPORTANT — PLEASE READ: Product information, photography and illustrations included in this publication were as accurate as possible at the time of printing. For further product information and changes, please visit our website at www.fleetwoodrv.com or contact your local Fleetwood dealer. Prices, materials, design and specifications are subject to change without notice. All weights, fuel, liquid capacities and dimensions are approximate. Fleetwood has designed its recreational vehicles to provide a variety of uses for its customers. Each vehicle features optimal seating, sleeping, storage and fluid capacities. The user is responsible for selecting the proper combination of loads (i.e. occupants, equipment, fluids, cargo, etc.) to ensure that the vehicle's capacities are not exceeded.