

# PROVIDENCE<sup>®</sup>

CLASS A DIESEL



Pacific Blue



Black Gold



Mocha



Iron



White Diamond

**FLEETWOOD**  
Driven to Explore

## INTERIOR DECORS

### Briarwood

#### LIVING/DINING ROOM



Dinette  
Cushions



Sofa &  
Recliner

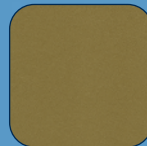

Sofa (optional)  
Recliner (optional)  
Driver & Front  
Passenger Seats

#### BEDROOM



Bedspread



Pillow Shams

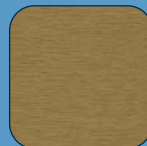

Throw Pillows

### Mineral

#### LIVING/DINING ROOM



Dinette  
Cushions

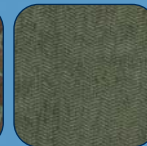

Sofa &  
Recliner

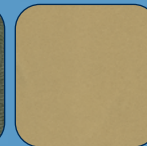

Sofa (optional)  
Recliner (optional)  
Driver & Front  
Passenger Seats

#### BEDROOM



Bedspread

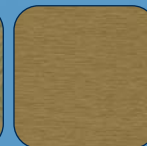

Pillow Shams



Throw Pillows

### Raven

#### LIVING/DINING ROOM



Dinette  
Cushions



Sofa &  
Recliner



Sofa (optional)  
Recliner (optional)  
Driver & Front  
Passenger Seats

#### BEDROOM



Bedspread

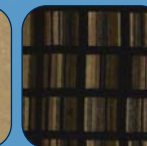

Pillow Shams



Throw Pillows

### Wood Finishes



Windsor Birch



Summit Ash



Plantation  
Cherry

# FLOOR PLANS

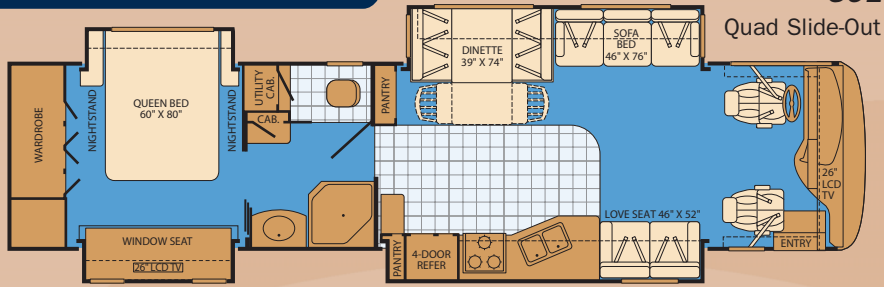

Interior Storage Capacity: 182 cu. ft.  
Exterior Storage Capacity: 162 cu. ft.

Available Options: 113, 126, 127, 128, 149, 173, 197, 200, 497, 821, 832, 833, 874

**39R**  
Full-Wall Slide  
Triple Slide-Out

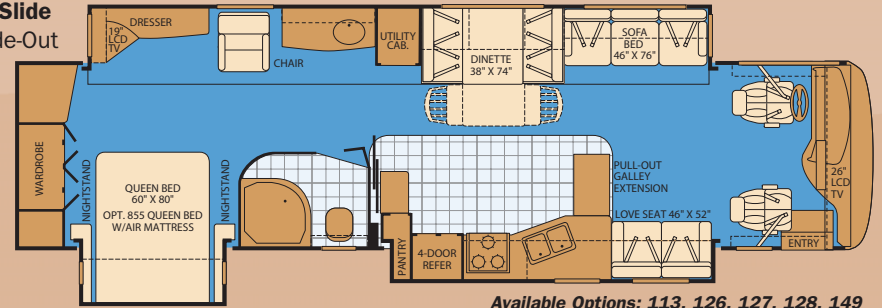

Interior Storage Capacity: 243 cu. ft.  
Exterior Storage Capacity: 201 cu. ft.

Available Options: 113, 126, 127, 128, 149, 173, 197, 200, 497, 821, 832, 833, 874

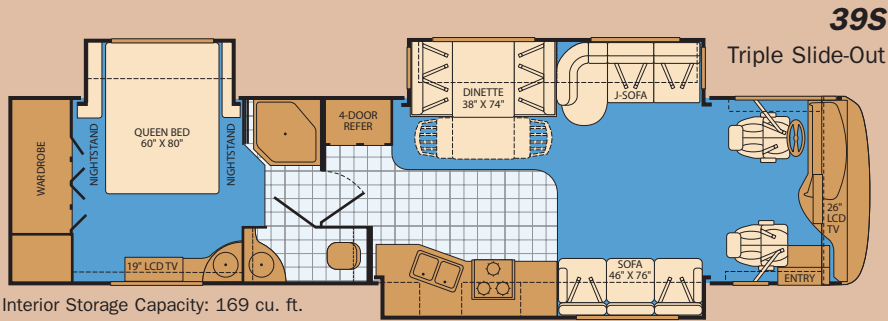

Interior Storage Capacity: 169 cu. ft.  
Exterior Storage Capacity: 162 cu. ft.

Available Options: 113, 126, 127, 128, 149, 175, 197, 200, 497, 804, 832, 833

**39V**  
Full-Wall Slide  
Double Slide-Out

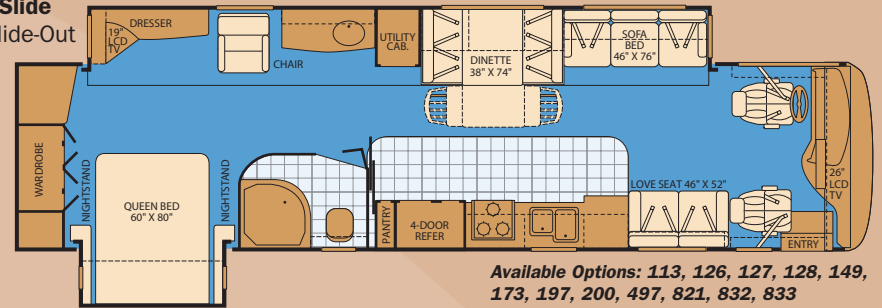

Interior Storage Capacity: 185 cu. ft.  
Exterior Storage Capacity: 189 cu. ft.

Available Options: 113, 126, 127, 128, 149, 173, 197, 200, 497, 821, 832, 833

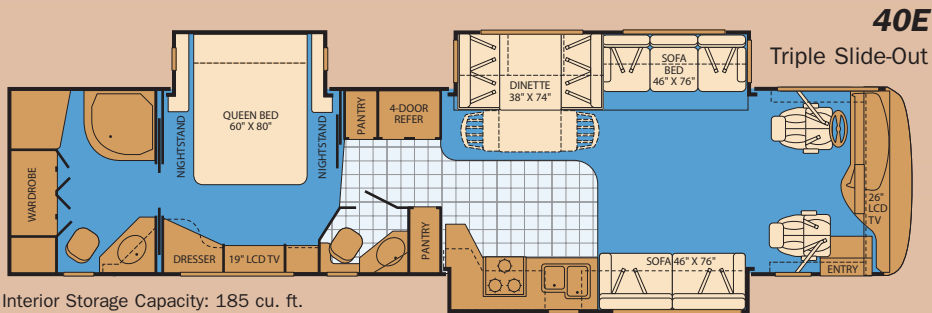

Interior Storage Capacity: 185 cu. ft.  
Exterior Storage Capacity: 199 cu. ft.

Available Options: 113, 126, 127, 128, 149, 175, 197, 200, 497, 804, 832, 833

**40X**  
Triple Slide-Out

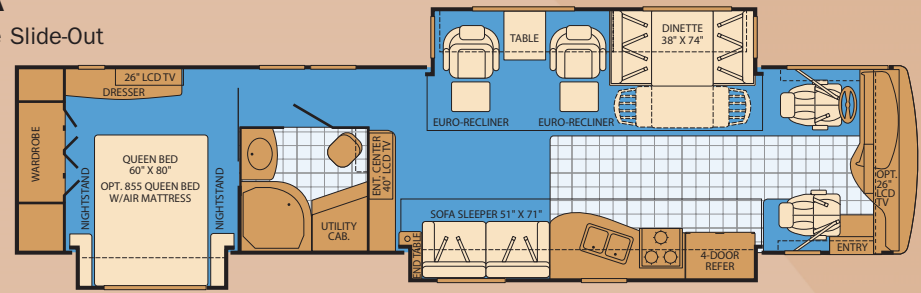

Interior Storage Capacity: 209 cu. ft.  
Exterior Storage Capacity: 206 cu. ft.

Available Options: 113, 126, 127, 128, 149, 174, 201, 497, 832, 833

# OPTIONS



OPT. 113  
3-BURNER  
RANGE  
W/OVEN



OPT. 126  
WASHER/  
DRYER

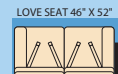

OPT. 173 ULTRALEATHER  
LOVE SEAT

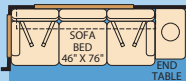

OPT. 174 ULTRALEATHER SOFA BED  
W/END TABLE AND LAMP

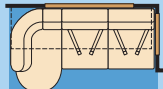

OPT. 175 ULTRALEATHER  
J-LOUNGE

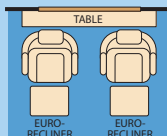

OPT. 197 DUAL SWIVEL  
RECLINERS W/TABLE



OPT. 200 ULTRALEATHER SOFA  
SLEEPER W/AIR MATTRESS



OPT. 201 ULTRALEATHER SOFA  
SLEEPER W/AIR MATTRESS



OPT. 497 PASSENGER SEAT  
W/FOOTREST

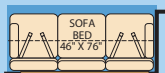

OPT. 804 ULTRALEATHER SOFA BED



OPT. 821  
RECLINER W/TABLE

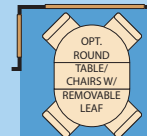

OPT. 832 FREE-STANDING  
DINETTE W/REMOVABLE LEAF

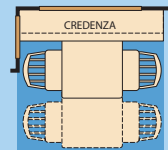

OPT. 833 FREE-STANDING  
DINETTE W/CREDENZA



OPT. 874  
DESK W/FOLD-UP CHAIR

## STANDARD FEATURES

### INTERIOR

#### INTERIOR - THROUGHOUT

- 10 Gallon Quick Recovery Water Heater w/Direct Spark Ignition (Gas/Electric)
- 20,000/25,000 BTU Dual Furnaces
- 20,000/30,000 BTU Dual Furnaces (Model 39V)
- 84" Interior Ceiling Height
- Complete TuffPEX Plumbing System
- Crown Molding w/Decorative Corner Caps
- Day/Night Pleated Shades
- Deluxe Roller Bearing, Full Extension Drawer Guides & Transit-Ship Locks
- Demand Water Pump w/Filter
- Dual Roof Mounted A/C High Efficiency w/Solar Panel & Chill Grill on Front A/C
- Hardwood Cabinet Doors/Drawers
- Plush Wall-to-Wall Carpet w/Carpet Pad
- Solid Surface Countertops and Sink Covers
- Vinyl Padded Ceiling
- Wall Switches (Includes Switches for Ceiling Lights & Vents)
- Water Heater Bypass
- Whole Coach Water Filtration System
- Wood Finish Return Air Intake for Furnace

#### DRIVER CONVENIENCE

- Adjustable 3 Point Seat Belts at Driver & Front Passenger Seats (with adjustable shoulder straps)
- AM/FM/CD Stereo w/Sirius® Satellite Radio (6 Month Subscription Included)
- Color Back-Up Monitor
- Adjustable Color Back-Up Camera
- Auxiliary Start Circuit
- Backlit Switches & Gauges
- Battery Shut-Off Switch
- CB Radio Ready
- Cruise Control
- Driver Side Manual Pull Down Shade
- Driver/Front Passenger Ultraleather™ Captain's Chairs w/Reclining Back/Slide Controls/Power/Heated/Adjustable Arms
- High-Output Auto A/C Heater Combo
- Passenger Armrest w/Integrated Magazine Rack
- Passenger Seat w/Power Footrest & Adjustable Armrest
- Power Driver/Front Passenger Sun Visors
- Radio Switch-Main/Auxiliary Power
- Soft Surface Automotive Dash w/Area for Laptop GPS (Laptop & GPS Not Included)
- Tilt/Telescoping Steering Wheel

#### GALLEY

- 1.4 cu.ft. Convection Microwave Oven w/Stainless Steel Front
- Norcold® 12 cu.ft. 4 Door Stainless Steel Refrigerator w/Ice Maker and Water Dispenser
- 3 Burner, High-Output Cook Top w/Sealed Burners
- Adjustable Cabinet Shelves (Select Cabinets)
- Fan-Tastic® Power Roof Vent w/Wall Switch
- Laminate Floor Tile
- Large, Double Stainless Steel Sink
- Raised Panel Cabinet Doors
- Single Lever Galley Faucet w/Pullout Sprayer
- Six Person Pull-Out Dinette Table (Select Models)

- Slide-Out Dinette Bins w/Latches
- Soap Dispenser
- Solid Surface Counter Top, Sink & Range Covers
- Under Galley Shelving & Wastebasket
- Window Over Sink

#### LIVING ROOM

- Samsung® 26" LCD Flat Screen TV (40" 40X Model)
- DSS/Stationary Auto Locating Satellite Dish (Covered)
- Samsung® DVD Home Theater Sound System w/Hidden Surround Sound Speakers
- Easy Sweep Laminate Flooring at Entry
- Flexsteel® Residential Seat Styling
- J-Lounge Ultraleather™ Sofa (Select Models)
- TV Antenna
- Ultraleather™ Sofa Bed

#### BEDROOM

- Samsung® 19" LCD TV Mounted on Wall (Select Models)
- Bedspread w/Decor Pillows
- Cabinet Storage Above the Bed
- Coffered Ceiling
- Mirrored Wardrobe Doors
- Remote Generator Start
- Restonic® Deluxe Pillow Top Innerspring Mattress
- Ventilated Rear Wardrobe w/Cedar Lining, Carpeted Floor & Wire Organizer
- Wardrobe Lighting
- Bedroom Entertainment Center w/26" LCD TV and Home Theater (Model 39L & 40X)

#### BATHROOM

- Cabinet Toe Kicks
- Coordinated Bath Accessories
- Fan-Tastic® Power Roof Vent w/Wall Switch
- Hardwood Bath Door/Trims
- Laminate Floor Tile
- Lighted Assist Handle
- Molded Shower Enclosure w/Skylight
- Porcelain Toilet w/Water Saver
- Stainless Steel Sink

#### SAFETY/CONVENIENCE

- Carbon Monoxide Detector/Alarm
- Energy Management System (EMS) w/Soft Start
- Fire Extinguisher
- Propane Detector/Alarm
- Smoke Detector/Alarm

### EXTERIOR

#### EXTERIOR - THROUGHOUT

- 120V/12V AC/DC Converter
- 120V/12V Wire Raceways
- 2000 Watt Pure Sine Wave Inverter w/Remote
- 4 Point Automatic Electric Levelers
- 50 Amp Service
- 8.0 kW Onan® Quiet Diesel Generator
- Awning Rail/Drip Molding (Both Sides)
- Choice of Five Colorway Graphics
- Dual Battery Charge Control
- Dual Pane Windows w/Screens
- Fiberglass Front Quarter Panels
- Fiberglass Front/Rear Caps w/High-Mounted Taillights

- Fiberglass Wheel Well Trims
- Full-Body Paint
- Solid Surface/Heated Exterior Rear View Mirrors
- Utility Compartment w/Exterior Shower
- Water Pump Switch (Multiple Locations)
- Weather Pro Power Awnings (Patio Awning Includes Wind Sensor)

#### AUTOMOTIVE

- 10,000 lb. Weight Distributing Hitch Receiver w/7-Pin Electrical Hook-Up
- 350HP 900 Mercedes 7.2L Engine
- Aluminum Wheels
- Dual Fuel Fill (One on Each Side)
- Fog Lamps
- Freightliner® Chassis
- Large Bonded-in One-Piece Windshield
- Mud Flaps
- Rear Vision Camera
- Single Motor Denso Windshield Wipers w/Wet Arm
- Tire Valve Extenders
- Underhood Utility Light

#### SAFETY/CONVENIENCE

- 20' Sewer Hose
- Central Electrical Panel
- Doorside Patio Receptacle
- Entry Door w/Screen Door & Deadbolt Lock
- Four 6V/Deep Cycle House Batteries
- Keyless Entry Remote
- Lighted Exterior Entry Assist Handle
- Park Cable Receptacle
- Porch Light (Doorside)
- Power Entry Step
- Roof Ladder
- Toilet Tank San-T-Flush™ System
- Touch Sensor Tank Monitoring System

#### STORAGE

- Continuous One Piece Compartment Bulb Seal
- EZ Store Compartment on Living Area Slide-Outs
- Gas Lift Strut Supports (Two-Stage Under Slide Box)
- Hidden, Stainless Steel Latch Rods
- Insulated Aluminum Luggage Doors w/Single Paddle Metal Latches & Stainless Steel Hinges
- Lighted Luggage Compartments
- Pass Through Compartment
- Side Swinging Luggage Doors (Selected Areas)
- Rotomolded Polyethylene Luggage Compartments
- Spare Tire Compartment (Spare Tire Not Included)

#### BODY STRUCTURE

- Aluminum Interlocking Floor/Wall/Ceiling Framing
- Color Coordinated Royal Tuff-Ply Roof
- Heated Water & Holding Tank Compartments
- Royal Tuff-Ply Radius Roof w/Ducted A/C
- Power Platform Construction (Fleetwood Exclusive)
- Vacu-bond® Upper/Lower Floors

## OPTIONS

#### INTERIOR - THROUGHOUT

- Automatic Generator Start System
- Central Vacuum System

- CSA Package (Canadian Specs)\*\*
- Heat Pumps
- Spot Light w/Remote Control
- Washer/Dryer
- Water Heater 16 Gallon Output

#### DRIVER CONVENIENCE

- Blind Spot/Security Vision Package

#### GALLEY

- 14 cu.ft. Dometic® Stainless Steel Frost-Free Refrigerator
- 12 cu.ft. Norcold® 4 dr w/wood inserts
- 14 cu.ft. Dometic® Frost-Free Refrigerator w/Wood Inserts
- 3 Burner Range w/Oven
- Free-Standing Dinette w/Credenza
- Free-Standing Table & Chairs
- Laminate Wood Flooring

#### LIVING ROOM

- Leather Euro Recliner
- Recliner w/Table (39L & 39V)
- Samsung® 26" LCD Flat Screen TV in Front Overhead (40X Only)
- Ultraleather™ Sofa Sleeper w/Air Mattress
- Leather Euro Swivel Recliner Free-Standing (Select Models)
- Desk (39L & 39R)

#### BEDROOM

- Sleep By Number Mattress

#### BATHROOM

- Laminate Wood Flooring

#### EXTERIOR - THROUGHOUT

- Entertainment Center w/Samsung® 19" TV and Stereo
- Diamond Shield Clear Front Protective Mask
- Pull-Out Grill and Kitchenette (Select Models)
- Window Awning Package

## FLEETWOOD ADVANTAGES

- **Full-Wall Slide (Patent Pending) (Fleetwood Exclusive)**
- **Mercedes MBE 900 7.2L 350HP Engine**
- **Vacu-bond® Walls w/Smooth High Gloss Exterior Tuff-Coat® Fiberglass**
- **Power Platform Construction (Fleetwood Exclusive)**
- **Large One-Piece Bonded-in Windshield**
- **Pass Through Storage**
- **Side Swinging Luggage Doors (Selected Areas)**
- **Samsung® 26" HD LCD TV in Living Room, Samsung® 19" HD LCD TV in Bedroom**
- **Deluxe Roller Bearing, Full Extension Guides**
- **84" Interior Ceiling Height**

\*\* CSA standards may require substitution or deletion to achieve conformance.

## WEIGHTS & MEASUREMENTS

### FREIGHTLINER® CHASSIS

MODELS	39L	39R	39S	39V	40E	40X
Engine Displacement (Liters)	7.2	7.2	7.2	7.2	7.2	7.2
Wheelbase (Inches)	252"	252"	252"	252"	276"	276"
GVWR (lbs) <sup>1</sup>	31,000	31,000	31,000	31,000	31,000	31,000
Front GAWR (lbs) <sup>2</sup>	12,000	12,000	12,000	12,000	12,000	12,000
Rear GAWR (lbs) <sup>2</sup>	19,000	19,000	19,000	19,000	19,000	19,000
Base Weight (lbs) <sup>3</sup>	24,000	24,000	23,700	24,000	24,000	24,000
GCWR (lbs) <sup>4</sup>	41,000	41,000	41,000	41,000	41,000	41,000
Hitch Rating Weight (lbs) <sup>†</sup>	10,000	10,000	10,000	10,000	10,000	10,000
Tongue Weight (lbs) <sup>†</sup>	1,000	1,000	1,000	1,000	1,000	1,000
Fuel Capacity (gal)	90	90	90	90	90	90

### DIMENSIONS & CAPACITIES

MODELS	39L	39R	39S	39V	40E	40X
Overall Length <sup>5</sup>	39' 6"	39' 6"	39' 6"	39' 6"	41' 6"	41' 6"
Overall Height (with A/C)	12' 10"	12' 10"	12' 10"	12' 10"	12' 10"	12' 10"
Overall Width (maximum) <sup>6, 7</sup>	102"	102"	102"	102"	102"	102"
Interior Height (maximum)	84"	84"	84"	84"	84"	84"
Interior Width (maximum)	96"	96"	96"	96"	96"	96"
Fresh Water Holding Tank (gal)	86	86	86	86	86	86
Grey Water Holding Tank (gal)	50	50	50	50	50	50
Black Water Holding Tank (gal)	50	50	50	50	50	50
Appliance Propane Tank (gal) (WC) <sup>8</sup>	38	38	38	38	38	38
Water Heater Tank (gal)	10	10	10	10	10	10

**Liquid Weight Reference:** Water (gal) = (8.3 lbs/3.8kgs) Fuel (gal) = 7.1 lbs/3.2 kgs) Propane (gal) = (4.2 lbs/1.9 kgs)

**Metric Conversion:** Multiply pounds x 0.453 to obtain kilograms. Multiply gallons x 3.785 to obtain liters. Multiply liters x 61 to obtain cubic inches.

### CHASSIS

**Model:** Freightliner®

**Alternator Amps:** 170 Amp Lecce Neville®

**Engine:** Mercedes MBE 900 7.2L 350HP

**Transmission:** Allison® 3000MH 6-Speed w/Electronic Shifter

**Torque:** 860 lbs-ft

- GVWR (Gross Vehicle Weight Rating) is the maximum permissible weight of this fully loaded motor home. The GVWR is equal to or greater than the sum of the (UVW) unloaded vehicle weight plus the (CCC) cargo carrying capacity\*.
- GAWR (Gross Axle Weight Rating) is the maximum permissible loaded weight a specific axle is designed to carry.
- Base Weight is the estimated weight of the motor home without fuel, options, water, cargo or passengers.
- GCWR (Gross Combined Weight Rating) is the value specified by the motor home manufacturer as the maximum allowable loaded weight of this motor home with its towed vehicle. Towing and braking capacities may be different. Refer to Fleetwood and chassis manufacturer's manuals for complete information.
- Length taken from front bumper to rear bumper (excludes accessories).
- Excludes safety equipment and awnings.
- Motor homes feature a body-width over 96" which will restrict your access to certain roads. Before purchasing, you should research any state and/or province road laws which may affect your usage.
- Tank manufacturer's listed water capacity (WC). Actual propane capacity is 80% of water listing as required by the safety code.

† The chassis manufacturer recommends the installation of a supplemental brake control system to activate the brakes on the vehicle or trailer you are towing. Hitch receiver ratings expressed are maximum for the hitch receiver installed and may require the purchase of additional equipment that is dependent on the weight of the towed load. Consult with hitch receiver manufacturer for further information.

N/A = not available at time of printing.

\* UVW and CCC are found on the cargo carrying capacity label in each RV.

**IMPORTANT — PLEASE READ:** Product information, photography and illustrations included in this publication were as accurate as possible at the time of printing. For further product information and changes, please visit our website at [www.fleetwoodrv.com](http://www.fleetwoodrv.com) or contact your local Fleetwood dealer. Prices, materials, design and specifications are subject to change without notice. All weights, fuel, liquid capacities and dimensions are approximate. Fleetwood has designed its recreational vehicles to provide a variety of uses for its customers. Each vehicle features optimal seating, sleeping, storage and fluid capacities. The user is responsible for selecting the proper combination of loads (i.e. occupants, equipment, fluids, cargo, etc.) to ensure that the vehicle's capacities are not exceeded.