

OPT. 863
DOUBLE BUNK BEDS

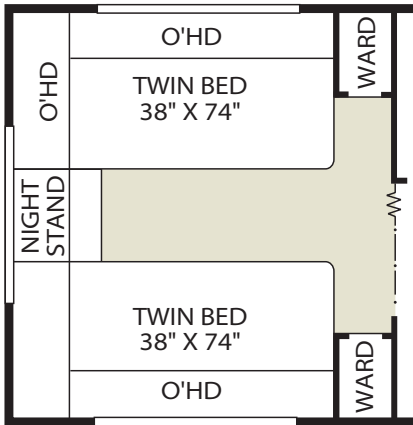

OPT. 835
TWIN BEDS W/NIGHTSTAND

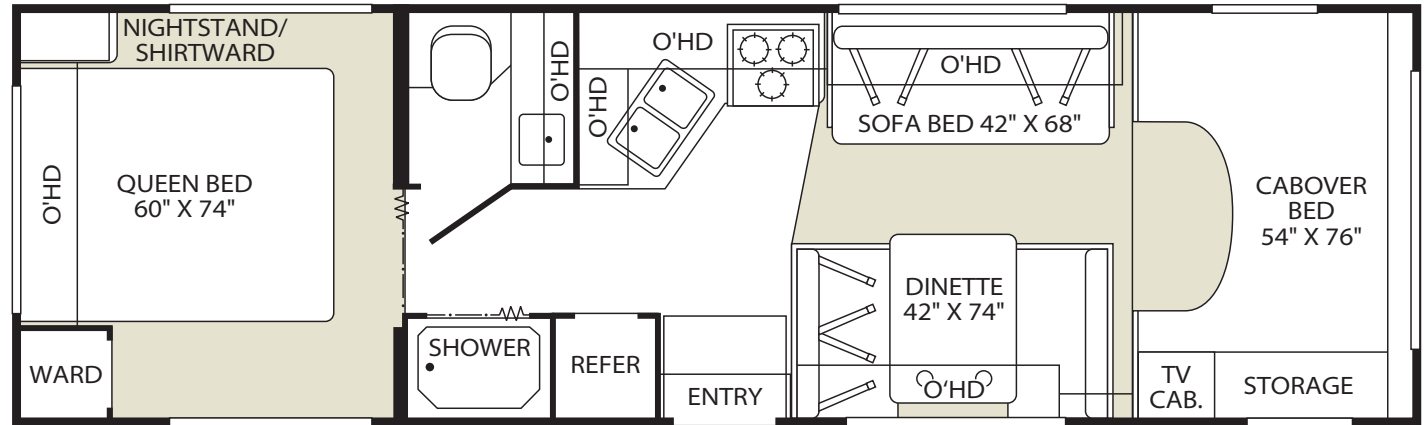

OPT. 026 20' AWNING

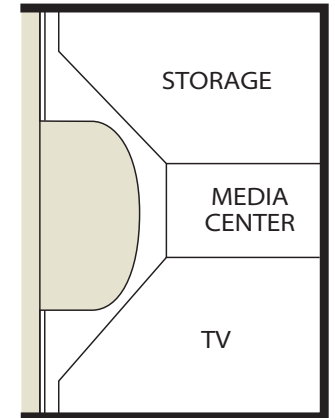

OPT. 086
ENTERTAINMENT CENTER

Jamboree 29V

MSRP \$65,849



Sleeping Accommodations: 6*



No Slideouts



30' 5"

CHASSIS

Specifications	Ford® E450	Chevy® Workhorse™
Wheelbase (inches)	198	199
Overall Length	30' 0"	30' 5"
GVWR (lbs) ¹	14,050	14,050
Front GAWR (lbs) ²	4,600	4,600
Rear GAWR (lbs) ²	9,450	9,450
Base Weight (lbs) ³	10,850	10,700
GCWR (lbs) ⁴	19,050	17,550
Tongue Weight (lbs) ⁵	500	350
Engine Displacement (Liters)	6.8	6
Hitch Rating Weight (lbs) ⁵	5,000	3,500
Engine	6.8L Triton® V10	6.0L Vortec™ V8
Horsepower	305 HP	300 HP
Torque	420 lb.-ft. @ 3250 RPM	360 lb.-ft. @ 3200 RPM
Transmission	5-Speed Automatic w/Overdrive 5R110W	4-Speed Automatic w/Overdrive 4L80E
Alternator Amps	130 Amp	145 Amp

DIMENSIONS AND CAPACITIES

Overall Length ⁶	30' 5"
Overall Height (with A/C) ⁷	10' 9"
Overall Width (maximum) ⁸	102"
Interior Height (maximum)	79"
Interior Width (maximum)	96"
Fresh Water Holding Tank (gal)	30
Gray Water Holding Tank (gal)	37
Black Water Holding Tank (gal)	37
Appliance LPG Tank (gal) (WC) ⁹	14
Water Heater Tank (gal)	6
Fuel Capacity (gal)	55

NOTE: Price shown is base MSRP (of the least inexpensive chassis, where a chassis option is available) and does not include accessories, options, freight, or taxes. Please see your dealer for exact pricing, which could exceed MSRP. Prices and specifications are subject to change without notice.

1. GVWR (Gross Vehicle Weight Rating): Means the maximum permissible loaded weight of the motor home. The GVWR is equal to or greater than the sum of the unloaded vehicle weight plus the net carrying capacity.

2. GAWR (Gross Axle Weight Rating): Means the maximum permissible loaded weight a specific axle

is designed to carry.

3. Base Weight: Means the estimated weight of the motor home without fuel, options, water, cargo or passengers.

4. GCWR (Gross Combined Weight Rating): Means the value specified by the motor home manufacturer as the maximum allowable loaded weight of this motor home with its towed vehicle. Towing and braking capacities may differ. Refer to Fleetwood and chassis manufacturer manuals for complete information.

5. The chassis manufacturer recommends the installation of a supplemental brake control system to activate the brakes on the vehicle or trailer you are towing.

6. Length taken from front bumper to rear bumper (excludes accessories).

7. Only if standard

8. Excludes safety equipment and awnings.

9. Tank Manufacturer's listed water capacity (WC). Actual LPG capacity is 80% of water listing as required by the safety code.

Seatbelt configuration may vary depending on options chosen.

Motor homes feature a body-width over 96" which will restrict your access to certain roads. Before purchasing, you should research any state and/or province road laws which may affect your usage.

*Sleeping accommodations are based on designed sleeping areas and may be greater than Sleeping Capacity Weight Rating (SCWR) found on the Cargo Carrying Capacity label located in each RV.

Sleeping accommodations are based on standard layout. Optional furniture may increase or decrease sleeping accommodations.

N/A = Not Available.

Liquid Weight Reference

Water (gal/Itrs) = (8.3 lbs/3.8 kgs), Gas (gal/Itrs) = (6.1 lbs/2.8 kgs), Diesel (gal/Itrs) = (7.1 lbs/3.2 kgs), LPG/Propane (gal/Itrs) = (4.2 lbs/1.9 kgs)

Metric Conversion

Multiply pounds x 0.453 to obtain kilograms, Multiply gallons x 3.785 to obtain liters

IMPORTANT-PLEASE READ: Product information, photography and illustrations included on this page were as accurate as possible at the time of publication. For further product information and changes, please contact your local Fleetwood dealer. Prices, materials, design and specifications are subject to change without notice. All weights, fuel, liquid capacities and dimensions are approximate. Fleetwood has designed its recreational vehicles to provide a variety of uses for its customers. Each vehicle features optimal seating, sleeping, storage and fluid capacities. The user is responsible for selecting the proper combination of loads (i.e. occupants, equipment, fluids, cargo, etc.) to ensure that the vehicle's capacities are not exceeded.